

1:10 dilution pipette

The Acura® dilute 810

Air displacement pipette with two pre-calibrated steps allows subsequent pipetting of 1 and 0.1 mL of the same liquid. Metal nozzle fits long straw tips to aspirate from narrow or deep reservoirs (i.e. Stomacher® bags). Ideal alternative to the graduated glass pipettes when performing serial 1:10 dilutions in bacteriology. Three-year warranty.

- Two pre-calibrated fixed volumes – no setting required
- Smooth activation, excellent ergonomics
- Interchangeable PE nozzle protection filter
- Justip™ system for height adjustment of tip ejector
- Independent calibration for each volume
- Easy maintenance, cleaning and disinfection
- Fully autoclavable at 121°C / 250°F

810

1 + 0.1 mL

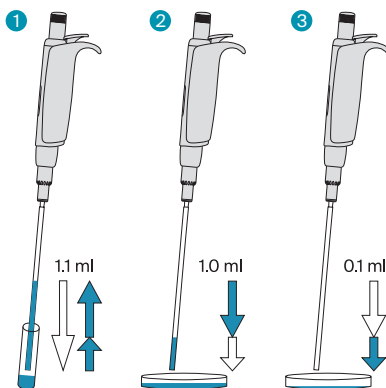

Simple operation

- 1 Depress plunger button in full, then release slowly to aspirate 1.1 mL
- 2 Depress plunger button to first stop, thus dispensing 1 mL in Petri dish
- 3 Depress plunger button to second stop, thus dispensing residual 0.1 mL in next Petri dish



No setting required

Two fixed volumes within one plunger travel.

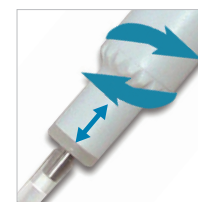

Justip™ ejector

Turn left or right to adjust ejector to straw tip position on the nozzle.



Straw tips

First class polypropylene. Size 190 mm. Specially designed for narrow vials and Stomacher® bags. Large diameter (4 mm) prevents blocking by particles in suspension.

Performance and ordering information - Instrument

Volume	Inaccuracy (E%)	Imprecision (CV%)	Cat. No.
1 mL	<± 0.5 %	< 0.4 %	810.1100
0.1 mL	<± 2.0 %	< 2.5 %	

Performance values obtained with bidest. water at constant temperature (± 0.5°C) comprised between 20 and 25° C in accordance with ISO 8655.

Ordering information - Accessories

Description	Packaging	Cat. No.
Straw tips, polypropylene, sterilized (L: 190 mm, Ø: 4 mm)	40x 25 / pk	313.1119.40
Nozzle protection filter, PE material	100 / pk	322.810
Pipette stand 340 for 3 pipettes	1 / pk	320.340
Shelf pipette holder 332 for 2 pipettes	1 / pk	320.332
Shelf pipette holder 332 for 2 pipettes, multipack	4 / pk	320.332.4